



### A Modular Sign System

*Accord 15 is a complete, modular system ideal for virtually any signage need, from simple personnel and identification signs, to complex directionals and directories. Offering easy, cost-effective signage solutions while retaining unparalleled design flexibility, modularity, and quality is what Accord 15 is all about.*



### End Clip System

Features a wide range of extruded aluminum bands (inserts) which snap onto low profile, integrally colored End Clips. It couldn't be easier! Ideal for personnel signs, directional modules, room identification, and ceiling and wall projection signs.

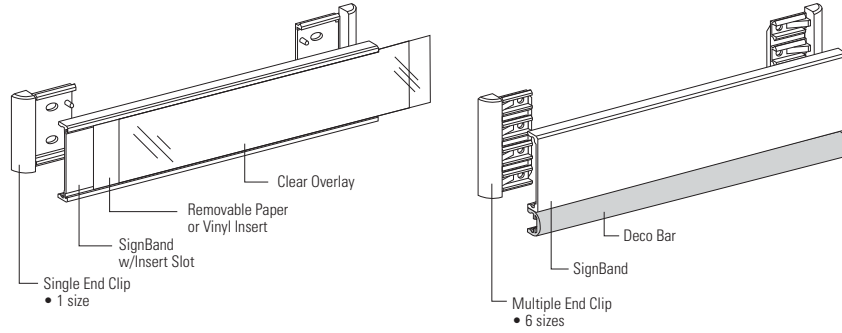

#### 1 End Clips

##### Single Insert Clips

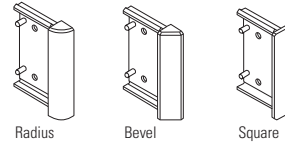

##### Multiple Insert Clips\*

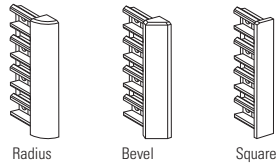

#### 2 Inserts

##### (Snap onto End Clips)

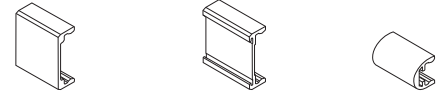

##### SignBand

- 8 Standard Sizes
- Custom Sizes Possible
- Curved Face Option

##### SignBand w/Insert Slot

- 5 Standard Sizes
- Compatible with APCO SignWord paper inserts or other changeable materials.

##### Decorative Element

- 3 Options/Shapes

\* Worldwide Patents Applied For  
 \*\* Contour Multiple EndClip also available in 30mm & 45mm sizes.  
 Contour NOT available from APCO USA Components Division.

### Side Track System

Features the same range of aluminum bands which snap onto aluminum Side Tracks via injection molded Clip fasteners, ensuring modularity and precise alignment of inserts. Ideal for room signs, directories, directional signs, poster holders, and more.

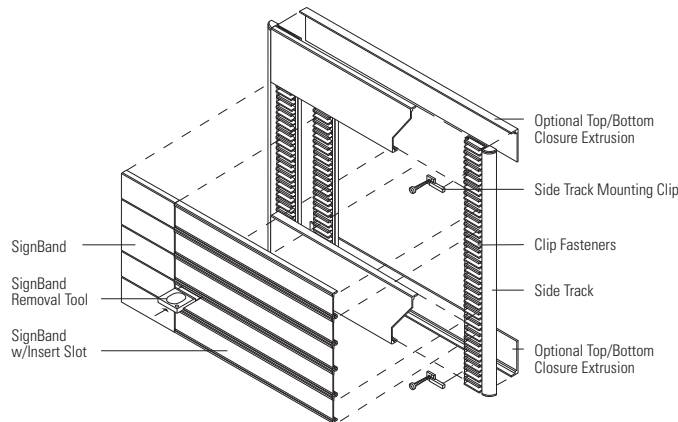

#### 1 Aluminum Side Tracks

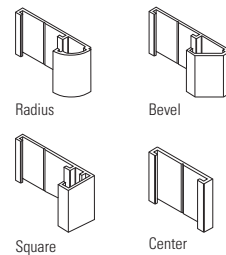

#### 2 Clip Fasteners

##### (Lock into Side Track)

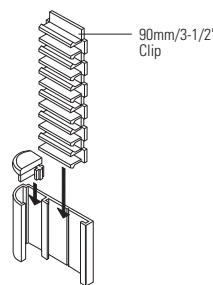

#### 3 Inserts

##### (Snap onto Clips)

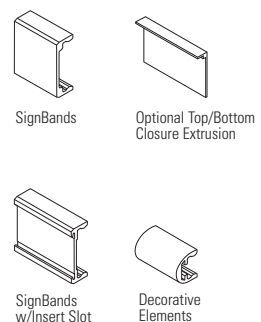

\* Contour NOT available from APCO USA Components Division.

### End Clip System - Common Applications

**The Essentials**

- Personnel Signs
- Information Signs
- Identification/Room Signs
- Conference Room Signs
- Directories
- Directionals

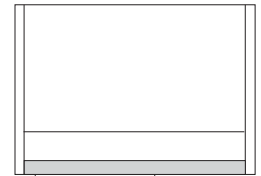
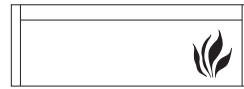

Your note here.

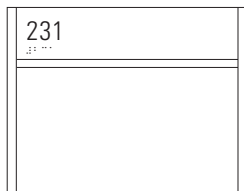
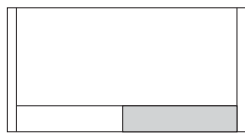

### Side Track System - Common Applications

**The Essentials**

- Information Signs
- Identification/Room Signs
- Conference Room Signs
- Window Signs
- Directories
- Directional Signs

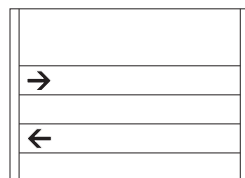
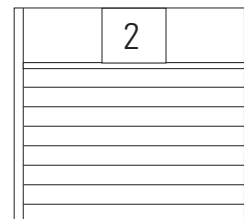
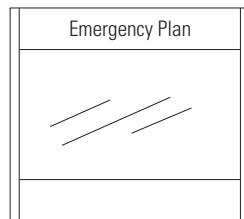
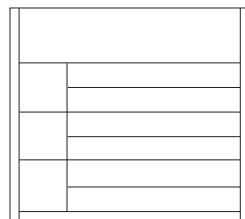
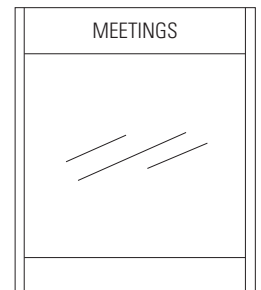
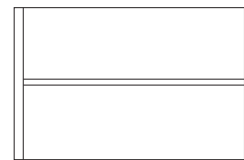
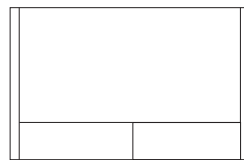

### Single Insert End Clips

#### Standard SignBand Insert

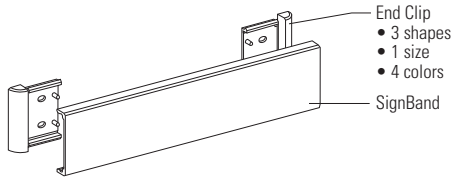

#### SignBand w/Insert Slot

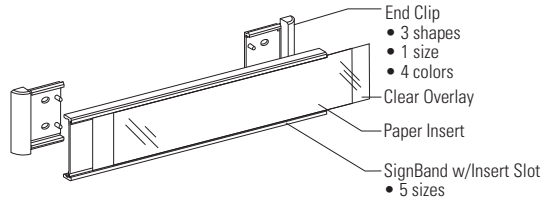

#### Split Column - No Visible Divider

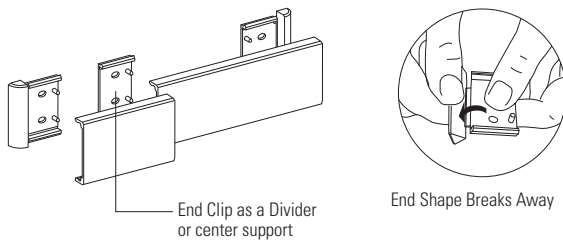

#### Split Column w/Square Divider

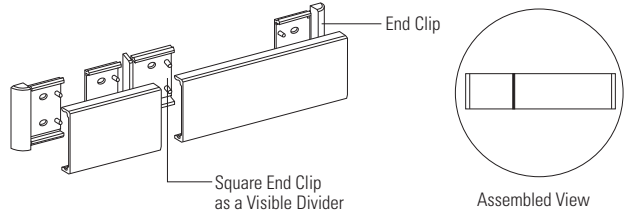

### Multiple Insert End Clips\*

#### SignBand Insert w/DecoBar

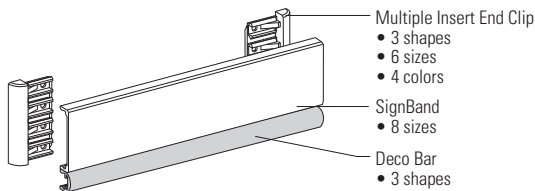

#### SignBand Insert w/Slider

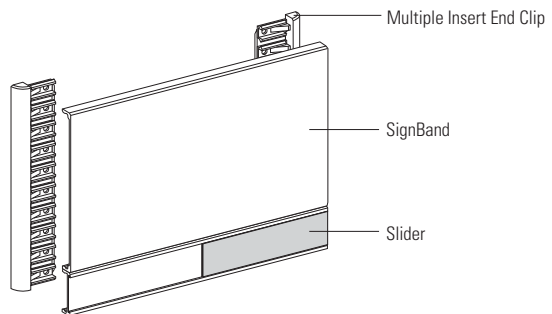

#### Split Columns - No Visible Divider

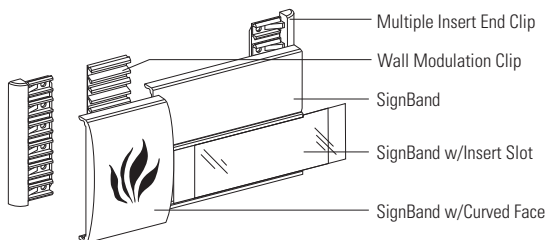

#### Split Columns w/Square Divider

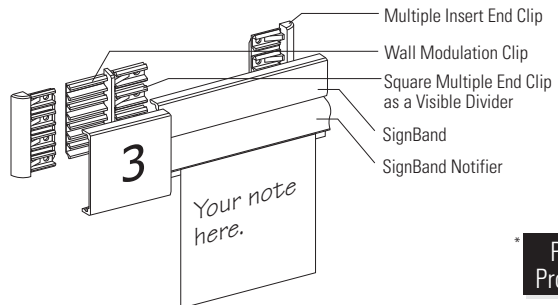

Patent Protected

### End Clip Installation Instructions

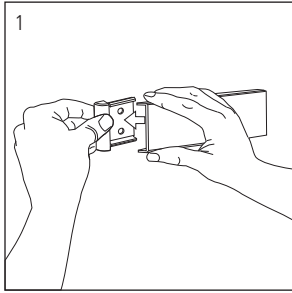

1 Snap End Clips onto each end of SignBand.

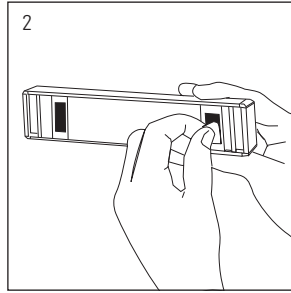

2 Apply recommended (see below) double sided adhesive\* to back of End Clips and remove backer. Then, press firmly onto position on mounting surface. \*\*\*

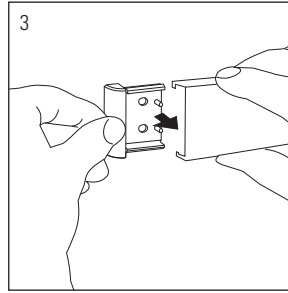

3 Do NOT remove SignBand until tape has reached cure time (1 hr). \*\*\* Otherwise, hold End Clips firmly while releasing SignBand.

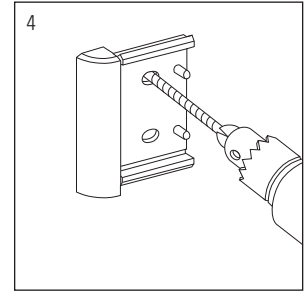

4 If desired, drill and screw mount through mounting holes for attachment to solid surfaces. It is recommended that you use a #6 screw.

### Removal and Replacement of Inserts (for single insert signs)\*\*

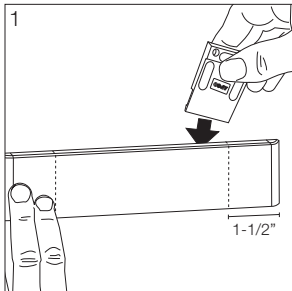

1 Insert Removal Tool, with logo facing outward, behind SignBand approximately 1-1/2" from end to avoid End Clip.

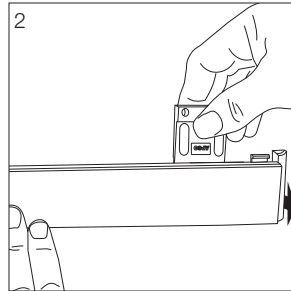

2 Apply light pressure to opposite end of band while pushing Removal Tool downward, behind SignBand.

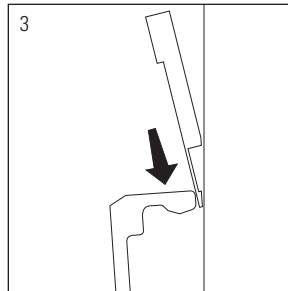

3 This creates a "wedge" effect that releases the SignBand from the End Clip.

### Fixing Methods

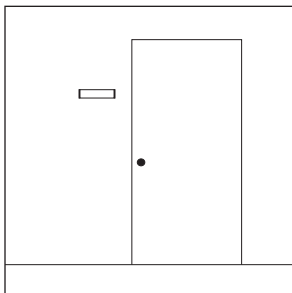

Wall Attachment  
(Vinyl Tape and/or Mechanical Fastening - see above)

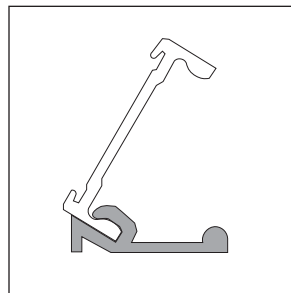

Desk Top

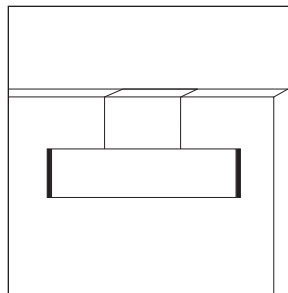

Panel Clip Attachment

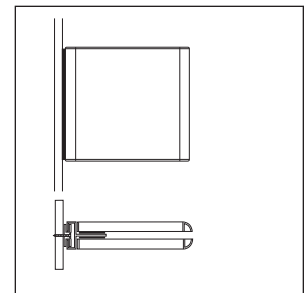

Projecting Attachment

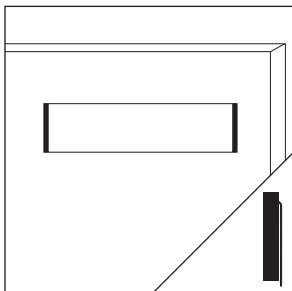

Pin Attachment (for Fabric Surfaces)

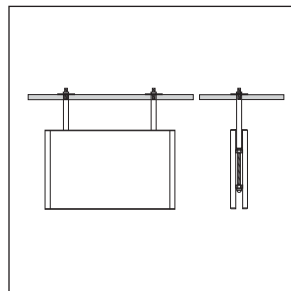

Ceiling Attachment

### IMPORTANT NOTES

- \* APCO recommends 1" x .045" thick tape for Single End Clips, and a 3/4"x.045" thick tape for Multiple End Clips. APCO supplies these tapes in roll form or pre-applied to End Clips. Use of non-approved tapes/sizes may drastically hinder the quality and performance of these signs.
- \*\* The procedure for Removal of Inserts for Multiple Insert EndClip signs is identical to Insert Removal Procedure illustrated on page 3.5.
- \*\*\* Vinyl tape may not be suitable for some wall surfaces and sign sizes. It is used at the sole discretion of the installer and, as such, APCO does not assume any responsibility for mounting failures that may occur.

### Side Track System

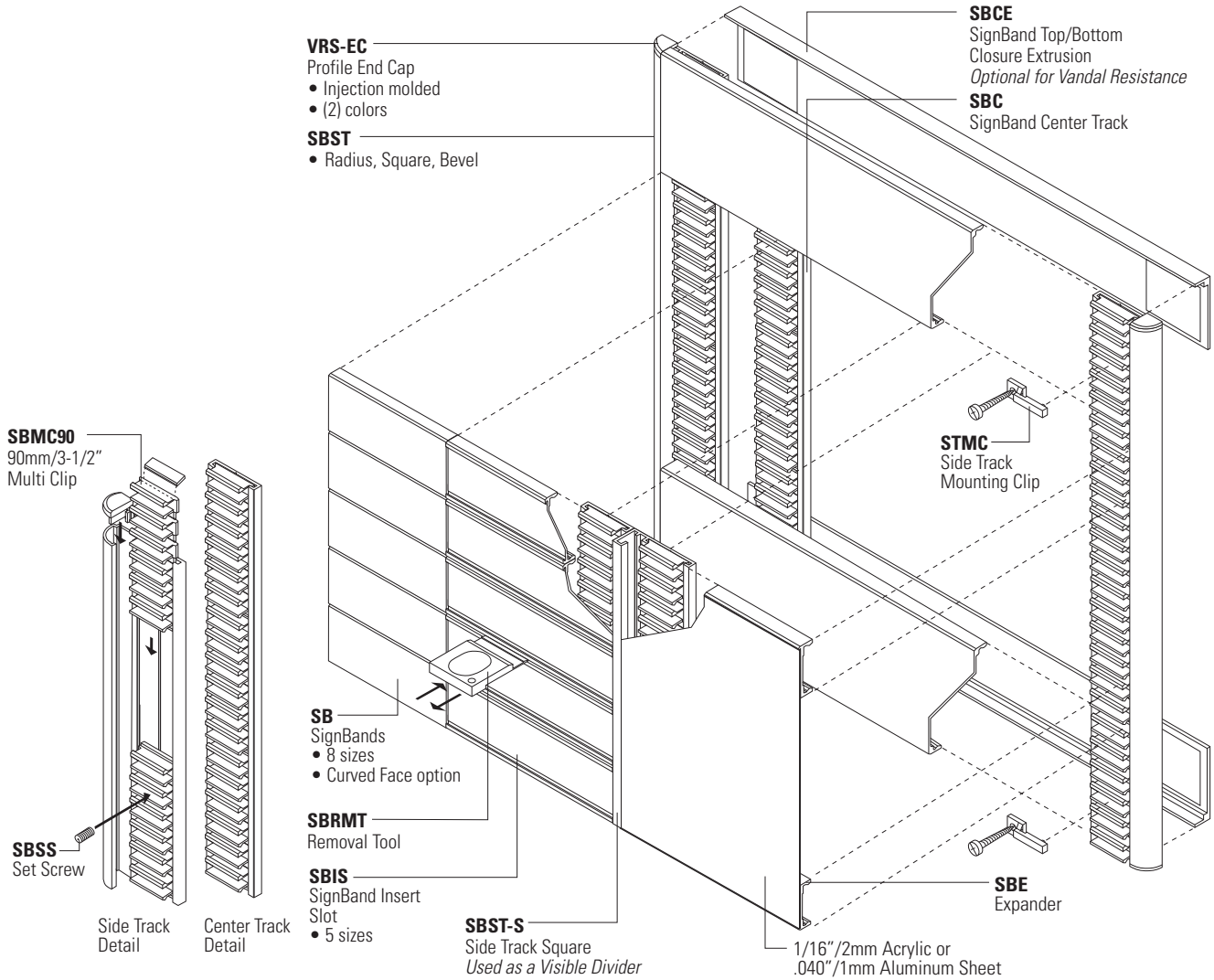

### Insert Removal and Replacement

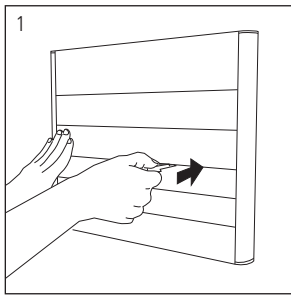

1  
Push Removal Tool between inserts at least 2" from Side Tracks and Center Tracks.

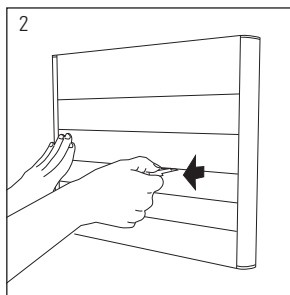

2  
Apply light pressure to one end of the SignBand requiring removal while pulling **straight out** to release the opposite end. Do NOT bend tool, as prying out will damage Tool and Clips.\*

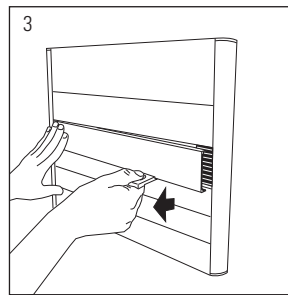

3  
With one end disengaged, pull outward to release other end.

**\*IMPORTANT NOTE:** In the rare event that Clips are damaged due to improper insert removal and/or vandalism, consult APCO for a **Clip Repair & Replacement Kit**.

Visit [www.apcocomponents.com](http://www.apcocomponents.com) for video instructions concerning removal and replacement of Accord 15 inserts.

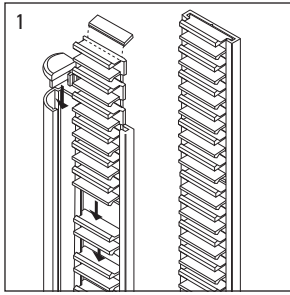

1  
Cut Side Tracks, and Center Tracks if necessary, and insert profile End Caps. To determine length of Tracks, total height of all inserts and subtract 6mm. [1"=25.4mm]  
Slide in appropriate number of 90mm Multi Clips, break/cut-away excess Clip at top of/above SideTrack profile, and affix with set screws or crimp Track edges.\*\* To calculate number of 90mm Multi Clips, total height of all inserts in millimeters; divide by (90) = number of 90mm Multi Clips per Track.  
NOTE: Be sure to always place Filler Clips (when used) between 90mm Full Clips, never at the very top or bottom of the Side Track.

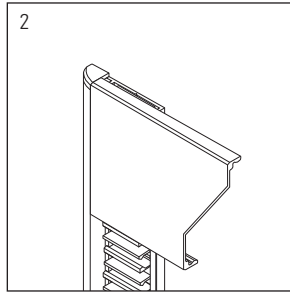

2  
Cut SignBands and decorative elements (if applicable) to size and snap into place. If custom sizes or types of materials are used, see below.

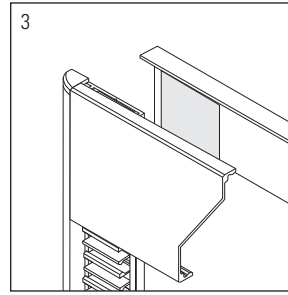

3  
If optional SignBand Top/Bottom Closure Extrusion is desired for added vandal resistance or aesthetic reasons, begin by cutting SBCE to **same length** as SignBands. Then apply tabs of specified adhesive (3M #4926) to the inside edge of the SBCE (as above), and on the back of the Center Tracks, if used. Then attach the SBCE to the back of the Side Tracks/Center Track by applying pressure. Repeat this step for the top and bottom of the sign, if desired.  
NOTE: If optional Closure Extrusion is desired for the top of the sign, adhesive is not necessary. Closure Extrusion may be "dropped" into position at the top of the sign after installation and will be held in position via gravity.

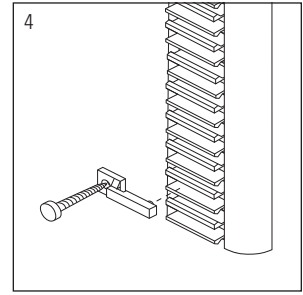

4  
If necessary attach assembled sign to wall surface with 1/16" double sided adhesive adhered to back of Side Tracks and Center Tracks. (APCO does NOT recommend the use of vinyl tape as the sole method of attachment for SideTrack signs.) Next, remove top & bottom inserts (or other inserts behind which you wish to fasten sign to wall) so the STMC's can be inserted into Clips. Once STMC's are attached in desired location (quantity and locations vary depending upon sign size, configuration, and weight), mechanically fasten through STMC holes.

**NOTE:** These instructions apply to most situations. However, for large signs, especially those over 24" (600mm) in height, consult APCO for more detailed construction and installation instructions.

### Exterior Installation

As plastic Clip Fasteners may expand/contract in extreme temperatures, consult APCO for important information and details concerning exterior use of Accord products.

\* For multi column modules, it is recommended to attach all Tracks to a common .040"/1mm back plate to keep all components together before installation. However, if Optional Closure Extrusions are used (3), this should NOT be necessary.

\*\* Clips may be secured to Tracks using (2) methods:

1) For permanent affixing, crimp the inside and outside edges at top and bottom of each track.

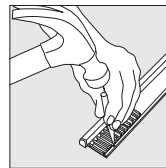

2) Or, a 5/64" socket head screw may be used in Clip holes at top and bottom, using the 3rd hole from the top and bottom of assembly.

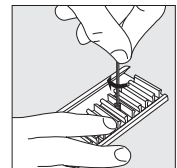

## Construction Instructions for Other Product Options

### Large Single Insert Signs\*

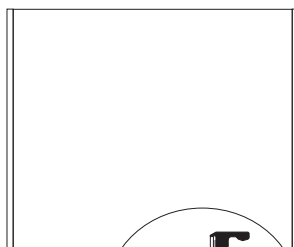

1mm/.040" Aluminum or 2mm/1/16" Acrylic  
SBE  
Adhesive

### Custom Inserts, Maps, Sizes, Etc.\*

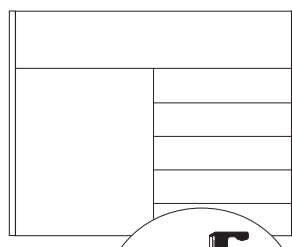

1mm/.040" Aluminum or 2mm/1/16" Acrylic  
SBE  
Adhesive

### Poster Holders/Window Signs\*

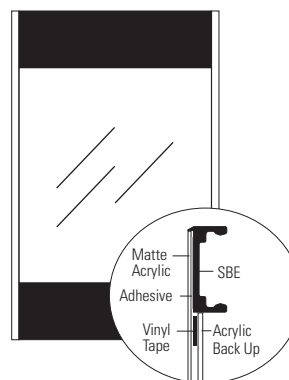

Matte Acrylic Adhesive  
SBE  
Vinyl Tape  
Acrylic Back Up

If using aluminum or acrylic inserts with SBE Expanders, to calculate cutting dimensions of the insert material, subtract 3mm from overall desired height to account for the top and bottom "lip" of the Expander extrusion.

\* IMPORTANT: Height of ALL Accord<sup>15</sup> inserts must be in 15mm increments!

### Molded Plastic End Clips

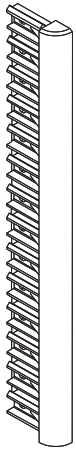

**SBEC210-R\***  
Radius (Multiple)  
210mm/8-1/4"

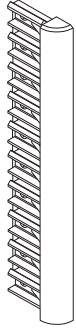

**SBEC150-R\***  
Radius (Multiple)  
150mm/5-7/8"

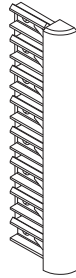

**SBEC120-R\***  
Radius (Multiple)  
120mm/4-3/4"

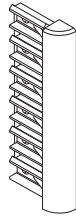

**SBEC90-R\***  
Radius (Multiple)  
90mm/3-1/2"

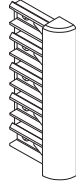

**SBEC75-R\***  
Radius (Multiple)  
75mm/3"

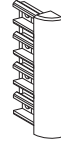

**SBEC60-R\***  
Radius (Multiple)  
60mm/2-3/8"

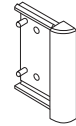

**SBEC45-R**  
Radius (Single)  
45mm/1-3/4"

**Other Shapes**  
Available in all sizes

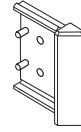

**SBEC-B**  
Bevel

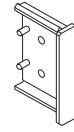

**SBEC-S**  
Square

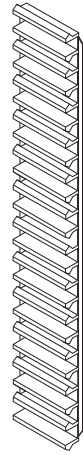

**SBWMC**  
SignBand Wall\*\*  
Modulation Clip  
150mm/5-7/8"  
For End Clip Signs

\* Patent Protected

\*\*For use with Multiple End Clip signs for center support if necessary and/or for split column signs.

### Aluminum Side Tracks & Related Components



**VRS-ECR**  
End Cap  
Radius



**VRS-ECB**  
End Cap  
Bevel



**VRS-ECS**  
End Cap  
Square

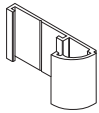

**SBST-R**  
Side Track  
Radius

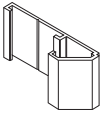

**SBST-B**  
Side Track  
Bevel

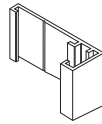

**SBST-S\***  
Side Track  
Square

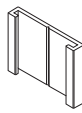

**SBCT\*\***  
Center

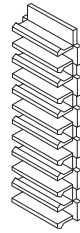

**SBMC90**  
Multiple Clip  
90mm/3.54"



**SBSS**  
SignBand Set Screw  
Used with SBMC90

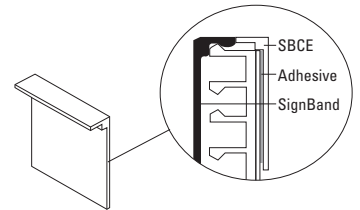

**SBCE**  
Optional Top/Bottom  
Closure Extrusion  
Side Track System Only

\* May also be used as a Column Divider.

\*\*Used ONLY as Column Dividers or Center Supports.

### Plastic Components Finishes

- A02** Black
- A43** Putty \*
- A72** Bone White \*
- A78** Pearl Grey

\* Not available for VRS End Caps

### Aluminum SideTrack Colors/Finishes

- Metallic Finishes**
- Natural Satin Anodized
  - Mill

**Note:**

Colors/Finishes may vary from market to market. Please contact APCO or your local APCO Distributor for availability of colors.

**IMPORTANT NOTE:** APCO recommends 1" x .045" thick tape for Single End Clips, and a 3/4"x.045" thick tape for Multiple End Clips. APCO supplies these tapes in roll form or pre-applied to End Clips. Use of non-approved tapes/sizes may drastically hinder the quality and performance of these signs.

### Standard SignBand Extrusions

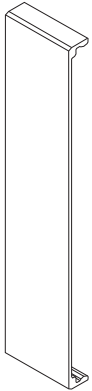

**SB150A**  
150mm/5-7/8"  
SignBand

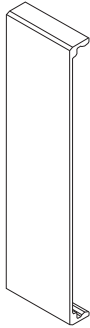

**SB120**  
120mm/4-3/4"  
SignBand

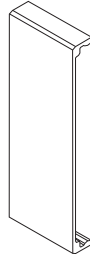

**SB90**  
90mm/3-1/2"  
SignBand



**SBC90**  
90mm/3-1/2"  
Curved Face

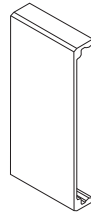

**SB75A**  
75mm/3"  
SignBand

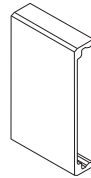

**SB60**  
60mm/2-3/8"  
SignBand

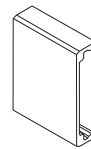

**SB45**  
45mm/1-3/4"  
SignBand

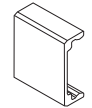

**SB30**  
30mm/1-1/8"  
SignBand



**SB15**  
15mm/9/16"  
SignBand

### Insert Slot Band Extrusions\*



**SB90IS**  
90mm/3-1/2"  
SignBand  
w/Insert Slot

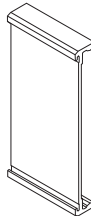

**SB75IS**  
75mm/3"  
SignBand  
w/Insert Slot

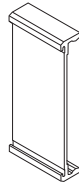

**SB60IS**  
60mm/2-3/8"  
SignBand  
w/Insert Slot

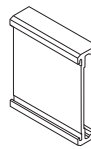

**SB45IS**  
45mm/1-3/4"  
SignBand  
w/Insert Slot

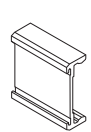

**SB30IS**  
30mm/1-1/8"  
SignBand  
w/Insert Slot

\* Can accommodate up to .020" thick material

### Decorative Elements



**SBDB-R**  
15mm/9/16"  
Deco Bar  
Radius



**SBDB-B**  
15mm/9/16"  
Deco Bar  
Bevel

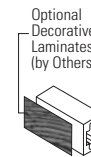

Optional  
Decorative  
Laminates  
(by Others)

**SBDB-OF**  
15mm/9/16"  
Deco Bar  
Optional Face

### Slider Extrusions

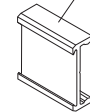
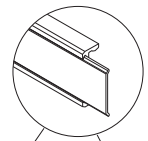

**SBSB**  
30mm/1-1/8"  
Slider Band

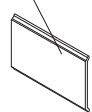

**SBSI**  
22mm/7/8"  
Slider Insert

### Expanders & Support Extrusions

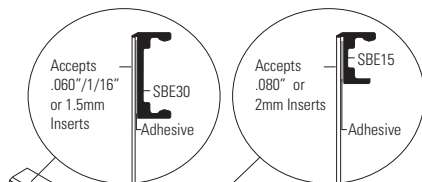

**SBE30**  
30mm/1-1/8"  
Expander



**SBE15**  
15mm/9/16"  
Expander  
*Generally for  
smaller signs*



**SBES**  
15mm/9/16"  
Support for  
SBE30 & SBE15  
Inserts

### Accord Express

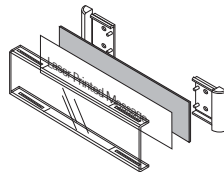

#### Clear Band

Injection molded crystal clear plastic for subsurface, laser printed inserts. Graphics are protected by the non-glare, clear plastic and are quickly and easily updated.



**SBP30-225-CL**  
30mm x 225mm  
(1-1/8" x 8-7/8")



**SBP45-225-CL**  
45mm x 225mm  
(1-3/4" x 8-7/8")



**SBP60-225-CL**  
60mm x 225mm  
(2-3/8" x 8-7/8")

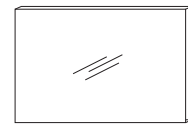

**SBP150-225-CL**  
150mm x 225mm  
(5-7/8" x 8-7/8")

### Standard Colors & Finishes

(Aluminum Components)

#### Metallic Finishes

- Natural Satin Anodized
- Mill

#### Note:

Colors/Finishes may vary from market to market. Please contact APCO or your local APCO Distributor for availability of colors.

### SignBand Removal Tool

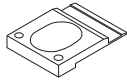

**SBRMT**  
SignBand  
Removal Tool

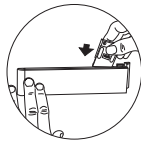

End Clip Signs



Side Track Signs

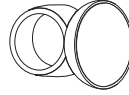

**SCT**  
Standard Suction  
Cup Tool

*For removal of Poster Holder inserts  
and Single Insert signs of the Accord  
Side Track system.*



### Accord<sup>15</sup> Notifier Message Strip

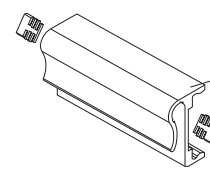

**SB30N**  
SignBand  
30mm Notifier

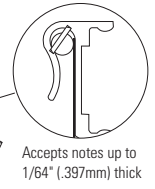

**SB30NRS**  
Notifier  
Roller Stops

Accepts notes up to  
1/64" (.397mm) thick

### Attachment/Installation Accessories & Adhesives

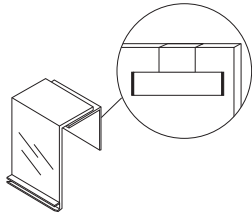

**SBPC**  
Panel Clip

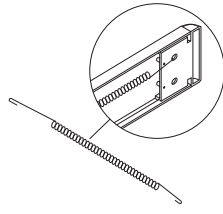

**SBECS**  
End Clip Spring  
For Panel Clip and Desk Sign  
modules over 45mm in height

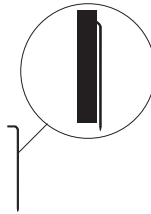

**PIN**  
PinLock Fastener  
For Fabric Surfaces

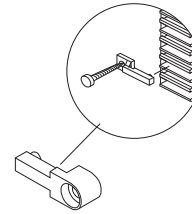

**STMC**  
Side Track  
Mounting Clip

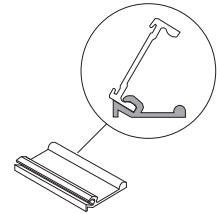

**SBDSE**  
Desk Sign  
Extrusion  
For SB30, 45, and 60

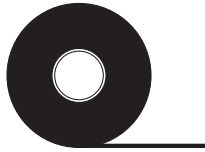

**ITH115**  
Multi-Clip  
Mounting Tape  
Call for Size



**ITH132**  
30mm Expander  
Mounting Tape  
Call for Size



**ITH102**  
15mm Expander  
Mounting Tape  
Call for Size



**ITH130**  
Closure Extrusion  
Attachment Tape

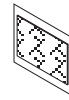

**ITH102**  
15mm Expander  
Mounting Tape  
Call for Size

### SignWord Inserts for Insert Slot & ClearBand Systems

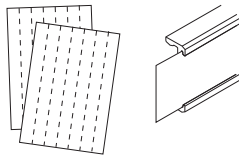

**SWPRO**  
SignWord Pro Software

#### SignWord Paper Colors

- A72** Bone White
- A43** Putty
- A47** Light Grey
- A78** Pearl Grey

Code	Works With	Length	Yield
<b>SWMS30</b>	SB30IS SBP30-225-CL	14"	400
<b>SWMS45</b>	SB45IS SBP45-225-CL	14"	250
<b>SWMS60</b>	SB60IS SBP60-225-CL	14"	150
<b>SWMS75</b>	SB75IS	14"	100
<b>SWMS90</b>	SB90IS	14"	100
<b>SWMS150</b>	SBP150-225-CL	11"	50

### Clear Overlay for Insert Slot

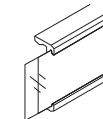
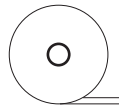

Code	Description	Length
<b>SWMS30C</b>	Overlay for SB30IS	25 ft. roll
<b>SWMS45C</b>	Overlay for SB45IS	25 ft. roll
<b>SWMS60C</b>	Overlay for SB60IS	25 ft. roll
<b>SWMS75C</b>	Overlay for SB75IS	25 ft. roll
<b>SWMS90C</b>	Overlay for SB90IS	25 ft. roll

**Ceiling Attachment Components**  
(End Clip System Only)

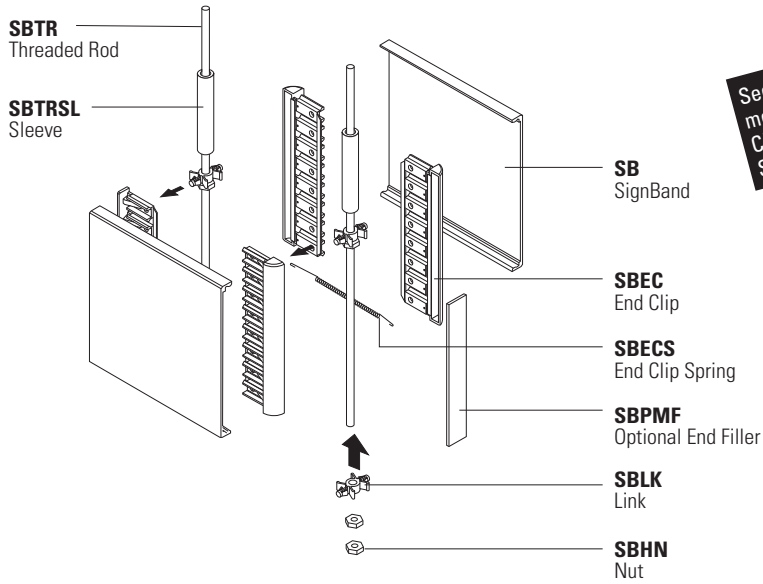

See Page 4.2 for an alternative method using the CMT and CMA extrusions of the APCO SignMatch System.

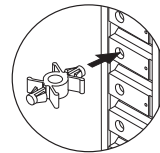

Link inserts horizontally for ceiling attachment.

**Projection Attachment Components**  
(End Clip System Only)

